

加一, 進檢

A

B

C

D

E

F

G

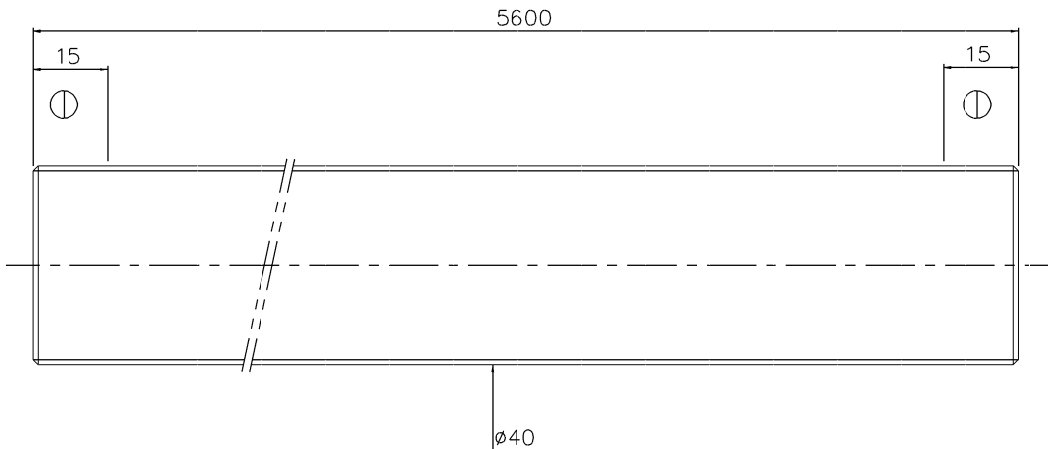

*BREAK SHARP EDGE UNLESS OTHER SPECIFIED

*未畫例者去毛邊

PRELOAD(kgf)	_____
R. D	35.41
S.F (kgf)	_____
DRAG TORQUE(Ng-cm)	_____
LUBRICATION	_____
DIRECTION OF TURN	RIGHT
PC DIA.	41.9
BALL DIA.	6.35
BALL TRACK FORM	GOTHIC
BACKLASH	_____
CIRCUIT	_____
LEAD ANGLE	16.9°
DYNAMIC (kgf)	_____
STATIC (kgf)	_____
LEAD/PITCH	40/10

SPEC: 4R40-40-5600-5600-0.05



CUSTOMER DRAWING NO.

MC TYPE

AXIAL TYPE



THREAD LENGTH	UNTOL DIMN	mm
UP	16	30
10	6	30
±0.1	±0.2	±0.3
UNTOL DIMN	mm	
300	600	1200
600	1200	2400
±0.5	±1.0	±1.5

UNCHECKED USE	CO. 5	C1	QC
ROUGH M/C/FIN M/C/I	0.40	0.05	
SCALE	1: X		
CUSTR	HIWIN STD.	DATE	C7.08'98
TITLE	BALL SCREW	DWG	盧文雄
MATERIAL	CF53	CHK	
DWG. NO.	A109N1A1	PROCESS NO.	A

DATE	C7.08'98
DWG	盧文雄
CHK	
APPD	

HIWIN® BALLSCREWS

* PLEASE IGNORE CHINESE CHARACTERS WHICH ARE FOR OUR REFERENCE ONLY.

DATE	MODIFICATION	APPROVED