

UNCONTROLLED IF PRINTED

$\sqrt{Ra6.3}$ ($\sqrt{Ra6.3}^G$)

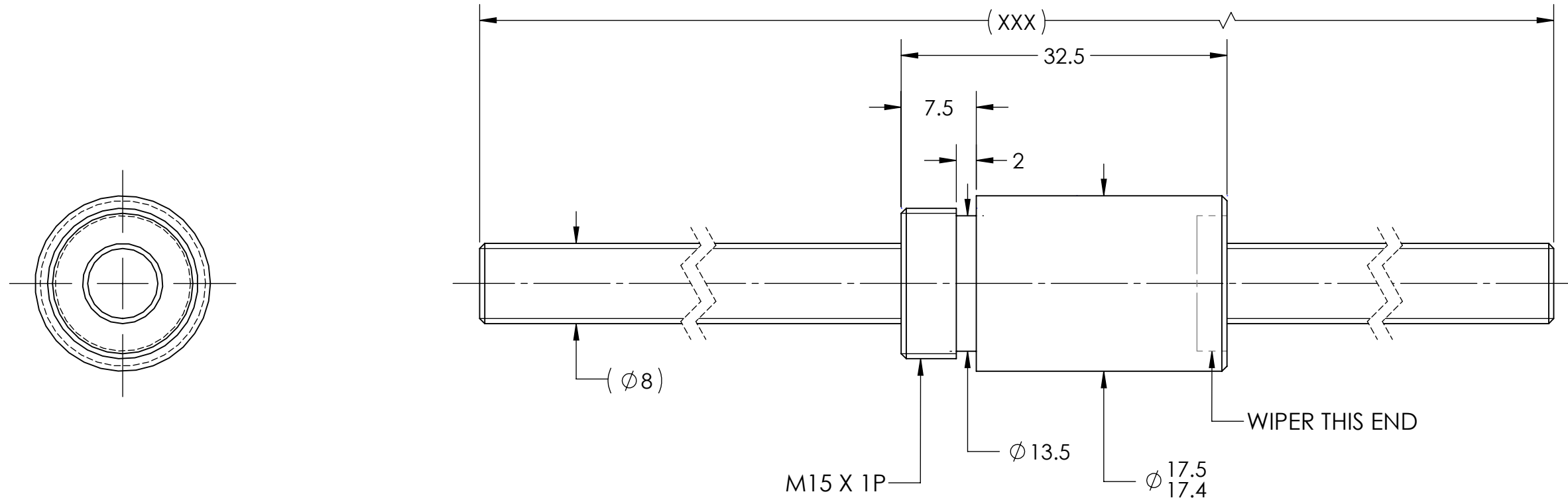

MD: 14.974
 MD: 14.794
 PD: 14.324
 PD: 14.206

BREAK SHARP EDGES UNLESS OTHERWISE SPECIFIED

PRELOAD(kgf)	~	ROUGH M/C	FIN M/C	GRD		MATERIAL	SHAFT:CF53/Equiv. NUT:SNCM220/Equiv.			
R.D.	6.158	$\sqrt{Ra25}$	$\sqrt{Ra6.3}$	$\sqrt{Ra0.4}$		THREAD BALL TRACK	HRC 56~62			
S.F. (kgf)	~	TOLERANCE mm								
DRAG TRQ(kgf-cm)	~	UP TO	6	30	120	300	600	1200	2400	OVER
TURN DIRECTION	R		± 0.1	± 0.2	± 0.3	± 0.4	± 0.5	± 0.8	± 1.0	± 1.5
P.C. DIA.	7.72	DATE	09/30/2022	INITIALS	HIWIN CORPORATION 12455 Jim Dhamer Dr, Huntley, IL 60142					
BALL DIA.	1.5	DRAWN	01/17/2023	D.W						
BACKLASH	0.01 MAX	CHECKED	01/17/2023	T.C.						
CIRCUIT	2.6*1	MFG APPR.	01/17/2023	A.H						
LEAD ANGLE	5.89			TITLE: STANDARD STOCK BALLSCREW						
DYNAMIC (kgf)	220	v300p: 0.05		PART NUMBER: R8-2.5B1-RSZ-XXX-XXX-0.05						
STATIC (kgf)	390	SIZE	B	DWG. NO.	W-SBS-8-2.5-A02		REV	N/C	SCALE	NTS
LEAD	2.5									

HIWIN CONFIDENTIAL